

UTILITY SURVEY DRAWING KEY

Abbreviations and Symbols

| | | |
|---------------------------------|------------------------|-------------------------------|
| EOT - End of trace | ED - Back drop | CL - Cover level |
| UTT - Unable to trace | CU - Cover level | IL - Invert level |
| FT - Floor trace | CL - Cover level | SL - S/L level |
| EB - Empty duct | SL - S/L level | SUL - Surcharge level |
| IR - Taken from records | SL - S/L level | WL - Water level |
| ARL - Assumed route | SL - S/L level | BL - Base level |
| UI - Unavailable information | SL - S/L level | UTS - Unable to survey |
| UTL - Unable to lift | SL - S/L level | UTR - Unable to read |
| D - Diameter | UTS - Unable to survey | UTR - Unable to read |
| Wd - Depth to water | UTS - Unable to survey | CW - Combined water sewer |
| SD - Depth to surcharge | UTS - Unable to survey | FW - Foul water sewer |
| or Electronically derived depth | UTS - Unable to survey | SW - Surface water sewer |
| CD - Depth to cover | UTS - Unable to survey | SP - Surface water sewer |
| HL - Depth to meet | UTS - Unable to survey | GP - Ground penetrating Radar |
| SD - Depth to sit | UTS - Unable to survey | NFI - No further information |
| | TV | Cable TV |
| | HV | High Voltage |
| | LV | Low Voltage |
| | EC | Electric Cables |
| | CCTV | Security Cable |
| | COM | Comms |
| | F | Fuel Line |
| | D | Empty Duct |
| | TL | Traffic Light Cable |
| | OP | Gas |
| | CP | Cable Pipe |
| | BT | British Telecom |
| | U | Unknown Trace |
| | W | Water |
| | FW | Foul Water Sewer |
| | SW | Surface Water Sewer |
| | UW | Utility Survey Extents |
| | | Other |
| | | Chamber Extents |
| | | End of Trace |

UTILITY SURVEY SITE NOTES

Record information shows 3 missing manholes on site. No evidence of this has been found, possibly buried or removed.

Disclaimer

General Notes

Electromagnetic techniques and/or ground penetrating radar have been used in the location of underground services. The results are not infallible and that excavations should be carried out to confirm service identification, positions and depths. Although all reasonable practices have been undertaken to detect buried services, the information cannot be guaranteed. The methods of the survey do not differentiate between live and dead services, and as such all services should be treated as live. Where services are non-metallic, these would be located with GPR. However services are likely to go undetected, if they are smaller than 2 inches, or below 2 metres. Where we have been unable to trace a service, we may show an assumed route. This is not to be treated as real.

Vertical & Horizontal Position

Vertical position (depth) is approximate to the trace. Drains may have been detected using a tracking wire, and the depth indicated could be between the bottom and top of the pipe. Horizontal position is indicative to the centre of the utility/service, and should not be taken as exact.

Warranty

Field marks may fade, no warranty is given in respect of the durability of the paint marks. Therefore this drawing should be used as the primary reference for the survey results. This drawing does not provide an absolute representation of the sub-surface. Utilities have been detected using non-invasive techniques only, and the performance can be adversely affected by ground, weather and site conditions. Therefore some utilities may be undetectable. While Landmark Surveys uses reasonable procedures to detect all utilities, it does not guarantee 100% detection will be achieved. Services at depths greater than 2m, will not be detectable.

Where a utility is shown on this drawing as a single line, this may represent multiple utilities. Where service records have been provided, Landmark Surveys will endeavour to match results in the field. However some results may coincidentally match a provided service location. This could result in false information being provided. Service and manhole details will be critical to the project design. Landmark Surveys would recommend that they enter into the chamber for an inspection using a specialist team qualified for confined space entry.

Inspective of the information provided by a utility survey and statutory pipeline excavation work should be undertaken with extreme caution and in accordance with HSE guidelines - HSG47 Avoiding danger from Underground services.

Ver. 2.9

REVISIONS/UPDATES & ASSOCIATED DETAILS

| Dwg No | Details | By | Date |
|--------|---------|----|------|
| | | | |



JOB TITLE
Utility Survey
Greenhill Hydrogen 2
Kimberly Clark
Coleshill

SHEET SIZE & SCALE
A0 @ 1:200
DATE SURVEYED
January 2023

DRAWING NUMBER
6491/U/01-03
DRAWN BY
MC

CLIENT
RES - Group

UTILITY SURVEY DRAWING KEY

| Abbreviations and Symbols | |
|---------------------------------|--------------------------------|
| EOT - End of trace | ED - Back drop |
| UTT - Unable to trace | CL - Cover level |
| FT - Floor trace | CL - Cover level |
| EL - Empty duct | IL - Invert level |
| IR - Taken from records | SL - S/L level |
| ARL - Assumed route | SL - Surface level |
| UI - Verbal information | BL - Base level |
| UL - Unable to lift | UL - Unable to lift |
| D - Diameter | UTS - Unable to survey |
| W - Depth to water | FW - Foul water sewer |
| SD - Depth to surcharge | CW - Combined water sewer |
| or Electronically derived depth | SW - Surface water sewer |
| CD - Depth to crown | GPR - Ground penetrating Radar |
| LD - Depth to meet | NFI - No further information |
| SD - Depth to sit | |
| TV | Cable TV |
| HV | High Voltage |
| LV | Low Voltage |
| EC | Electric Cables |
| CCTV | Security Cable |
| COM | Comms |
| F | Fuel Line |
| D | Empty Duct |
| TL | Traffic Light Cable |
| TL | Gas |
| P | Oil Pipe |
| B | Broad Telecom |
| U | Unknown Trace |
| W | Water |
| FW | Foul Water Sewer |
| CW | Combined Water Sewer |
| SW | Surface Water Sewer |
| US | Utility Survey Extents |
| Other | Other |
| Chamber Extents | |
| End of Trace | |

UTILITY SURVEY SITE NOTES

Record information shows 3 missing manholes on site. No evidence of this has been found, possibly buried or removed.

Disclaimer

General Notes

Electromagnetic techniques and/or ground penetrating radar have been used in the location of underground services. The results are not infallible and that excavations should be carried out to confirm service identification, positions and depths. Although all reasonable practices have been undertaken to detect buried services, the information cannot be guaranteed. The methods of the survey do not differentiate between live and dead services, and as such all services should be treated as live. Where services are non-metallic, these would be located with GPR. However services are likely to go undetected, if they are smaller than 2 inches, or below 2 metres. Where we have been unable to trace a service, we may show an assumed route. This is not to be traced as such.

Vertical & Horizontal Position
Vertical position (depth) is approximate to the trace. Drains may have been detected using a tracing wire, and the depth indicated could be between the bottom and top of the pipe. Horizontal position is indicative to the centre of the utility/service, and should not be taken as exact.

Warranty
Field marking may fade, no warranty is given in respect of the durability of the paint marks. Therefore this drawing should be used as the primary reference for the survey results. This drawing does not provide an absolute representation of the sub-surface. Utilities have been detected using non-invasive techniques only, and the performance can be adversely affected by ground, weather and site conditions. Therefore some utilities may be undetectable. While Landmark Surveys uses reasonable procedures to detect all utilities, it does not guarantee 100% detection will be achieved. Services at depths greater than 2m, will not be detectable.

Where a utility is shown on this drawing as a single line, this may represent multiple utilities. Where service records have been provided, Landmark Surveys will endeavour to match results in the field. However some results may conceivably match a provided service location. This could result in false information being provided. Service and manhole details will be critical to the project design. Landmark Surveys would recommend that entry into the chamber be undertaken using a specialist team qualified for confined space entry.

Inspecification of the information provided by a utility survey and statutory plans, excavation work should be undertaken with extreme caution and in accordance with HSE guidelines - HSG47 Avoiding danger from Underground services.

Ver. 2.9

REVISIONS/UPDATES & ASSOCIATED DETAILS

| Dwg No | Details | By | Date |
|--------|---------|----|------|
| | | | |



JOB TITLE
 Utility Survey
 Greenhill Hydrogen 2
 Kimberly Clark
 Coleshill

SHEET SIZE & SCALE
 A0 @ 1:200

DATE SURVEYED
 January 2023

DRAWING NUMBER
 6491/U/02-03

DRAWN BY
 MC

CLIENT
 RES - Group

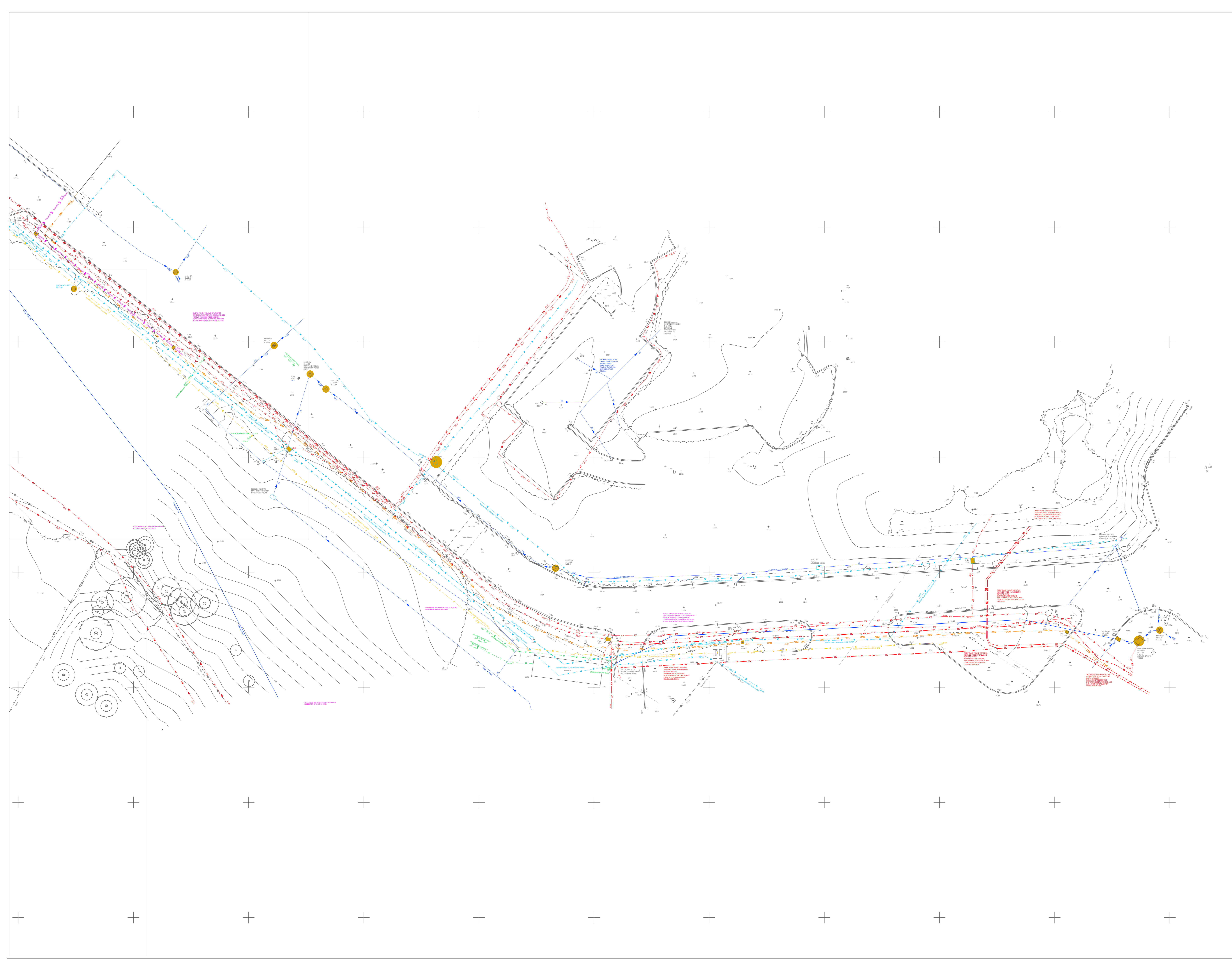



UTILITY SURVEY DRAWING KEY

Abbreviations and Symbols

| | |
|-----------------------------------|-------------------------------|
| EOT - End of trace | CL - Cover level |
| UTT - Unable to trace | CL - Cover level |
| FT - Floor trace | CL - Cover level |
| EL - Empty duct | IL - Invert level |
| IR - Taken from records | SL - S/L level |
| AR - Assumed route | SL - Surface level |
| UI - Untrace information | SL - Surface level |
| UL - Unable to lift | SL - Surface level |
| U - Untrace | SL - Surface level |
| W - Depth to water | UTS - Unable to survey |
| SD - Depth to surcharge | FW - Full water sewer |
| ED - Electronically derived depth | CW - Combined water sewer |
| CD - Depth to cover | SW - Surface water sewer |
| LD - Depth to meet | GP - Ground penetrating Radar |
| SD - Depth to sit | NFI - No further information |

| | |
|-------|------------------------|
| TV | Cable TV |
| HV | High Voltage |
| LV | Low Voltage |
| EC | Electric Cables |
| CCTV | Security Cable |
| COM | Comms |
| FL | Fuel Line |
| D | Empty Duct |
| TL | Traffic Light Cable |
| TL | Gas |
| CP | Oil Pipe |
| BT | Broad Telecom |
| U | Unknown Trace |
| W | Water |
| FW | Foul Water Sewer |
| CW | Combined Water Sewer |
| SW | Surface Water Sewer |
| U | Utility Survey Extents |
| Other | Other |

| |
|-----------------|
| Chamber Extents |
| End of Trace |

UTILITY SURVEY SITE NOTES

Record information shows 3 missing manholes on site. No evidence of this has been found, possibly buried or removed.

Disclaimer

General Notes
 Electro-magnetic techniques and/or ground penetrating radar have been used in the location of underground services. The results are not infallible and that excavations should be carried out to confirm service identification, positions and depths. Although all reasonable practices have been undertaken to detect buried services, the information cannot be guaranteed. The methods of the survey do not differentiate between live and dead services, and as such all services should be treated as live. Where services are non-metallic, these would be located with GPR. However services are likely to go undetected, if they are smaller than 2 inches, or below 2 meters. Where we have been unable to trace a service, we may show an assumed route. This is not to be traced as such.

Vertical & Horizontal Position
 Vertical position (depth) is approximate to the trace. Drains may have been detected using a tracing wire, and the depth indicated could be between the bottom and top of the pipe. Horizontal position is indicative to the centre of the utility/service, and should not be taken as exact.

Warranty
 Field marks may fade, no warranty is given in respect of the durability of the paint marks. Therefore this drawing should be used as the primary reference for the survey results. This drawing does not provide an absolute representation of the sub-surface. Utilities have been detected using non-invasive techniques only, and the performance can be adversely affected by ground, weather and site conditions. Therefore some utilities may be undetectable. While Landmark Surveys uses reasonable procedures to detect all utilities, it does not guarantee 100% detection will be achieved. Services at depths greater than 2m, will not be detectable.

Where a utility is shown on this drawing as a single line, this may represent multiple utilities. Where service records have been provided, Landmark Surveys will endeavour to match results in the field. However some results may conceivably match a provided service location. This could result in false information being provided. Service and manhole details will be critical to the project design. Landmark Surveys would recommend that entry into the chamber for confirmation using a specialist team qualified for confined space entry.

In spite of the information provided by a utility survey and statutory plans, excavation work should be undertaken with extreme caution and in accordance with HSE guidelines - HSG47 Avoiding danger from Underground services.

Ver. 2.9

REVISIONS/UPDATES & ASSOCIATED DETAILS

| Dwg No | Details | By | Date |
|--------|---------|----|------|
| | | | |



JOB TITLE
 Utility Survey
 Greenhill Hydrogen 2
 Kimberly Clark
 Coleshill

SHEET SIZE & SCALE
 A0 @ 1:200

DATE SURVEYED
 January 2023

DRAWING NUMBER
 6491/U/03-03

DRAWN BY
 MC

CLIENT
 RES - Group